

December 9th, 2019



OPTIONS PRESENTATION



MONROE SCHOOL
DISTRICT



AGENDA

- **INTRODUCTION**
- **DRAWING - OPTION 5**
- **COST SUMMARY OF OPTIONS 1-5**
- **SIGNIFICANT INCLUSIONS & EXCLUSIONS
- OPTIONS 1, 3 & 5**
- **DRAFT SCHEDULE**
- **OPEN DISCUSSION**





OPTION 5 - DRAWING



OPTION 5 - NEW/REMODEL HS AT EXIST HS SITE & ABE STAYS OPEN

LOWER LEVEL FLOOR PLAN

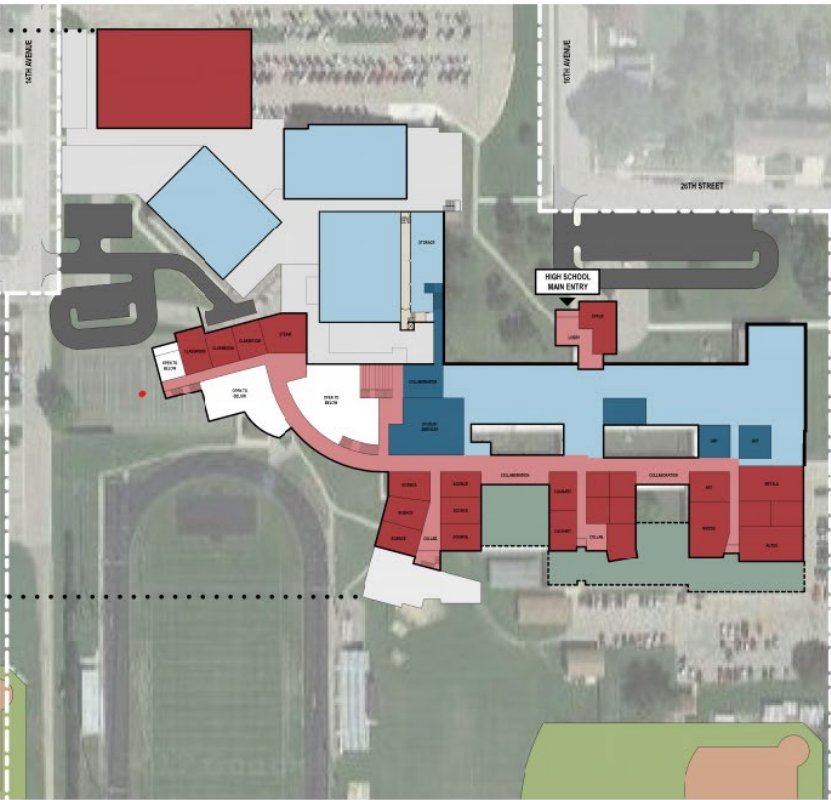
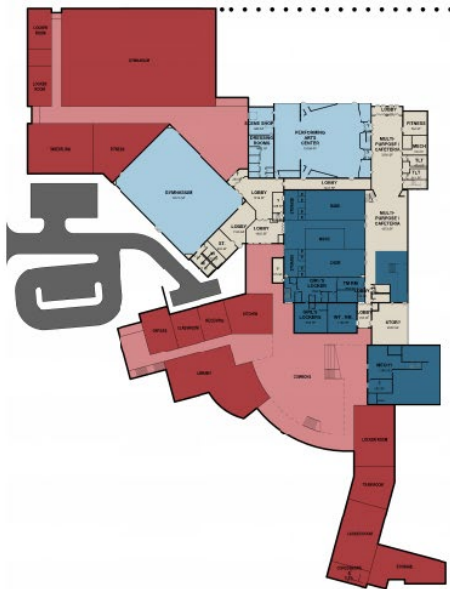

- ADDITION
- ADDITION (CORRIDOR)
- HEAVY RENOVATION
- RENOVATION

NORTH
SCALE: 1"=40'-0"

FIRST FLOOR PLAN

©2018 Plunkett Raysich Architects, LLP. 2/20/2018 10:41:53 AM

COST ESTIMATE SUMMARY – OPTIONS 1-5

	Option 1	Option 2	Option 3	Option 4	Option 5
Description	New/Remodel MS/HS at Exist HS Site & Close Abe	New HS at New Site, Close Exist HS & Close Abe	New HS at New Site, Close Exist HS & Abe Open	New/Remodel HS at Exist HS Site & Close Abe	New/Remodel HS at Exist HS Site & Abe Open
High School Subtotal	\$84,089,089	\$84,509,515	\$84,509,515	\$77,681,594	\$77,681,594
Middle School Subtotal	\$995,725	\$0	\$0	\$0	\$0
Northside Elementary Subtotal	\$0	\$19,377,115	\$0	\$19,377,115	\$0
Parkside Elementary Subtotal	\$0	\$0	\$0	\$0	\$0
Abe Lincoln Elementary Subtotal	\$823,780	\$823,780	\$351,025	\$823,780	\$351,025
TOTAL	\$85,908,593	\$104,710,410	\$84,860,540	\$97,882,488	\$78,032,619

OPTION 1 – INCLUSIONS & EXCLUSIONS

High School / Middle School

- Grades 7-12 configuration
- 227,000 sqft of new additions / 144,500 sqft of renovating existing space
- Demolition of 60,000 sqft of the existing High School
- Level 1 Remodel includes floors, paint, ceilings, LED lights, HVAC upgrades & (400) lockers
- Level 2 Remodel includes floors, paint, ceilings, minor electrical, LED Lights & HVAC upgrades
- Level 3 Remodel includes floors, paint, ceilings, some new walls, minor plumbing, electrical, LED lights & HVAC upgrades.
- Allowance of \$3M for athletic fields (i.e. (1) baseball field, (2) soccer fields, (8) tennis courts & artificial turf)
- Upgrade front façade
- Repair water leaks & drainage issues
- Replace existing built up & low R-value roofs
- Fire protection system
- Existing PAC upgrades (i.e. rigging, lights, sound, seats, floor, paint & curtain)
- Existing Gym upgrades (i.e. AC, floor, lighting, paint, acoustical panels, scoreboard, basketball hoops & bleachers for two Gyms)

Middle School

- Grades 4-6 configuration
- Remodel Allowance of \$996K (ADA Toilet Room upgrades completed in the summer of 2019)

Northside Elementary School

- Grades PK-3 configuration
- No referendum work

Parkside Elementary School

- Grades PK-3 configuration
- No referendum work (HVAC, LED lighting, fire protection, ceiling replacement, Library refresh and ADA Toilet Room upgrades completed in the summer of 2019)

Abe Lincoln Elementary School

- Close school (Demo building & restore site)

\$85,908,593

OPTION 3 – INCLUSIONS & EXCLUSIONS

High School (New)

- Grades 9-12 configuration
- 264,643 sqft new high school
- Performing Arts Center (PAC)
- 4-Station Gym
- Demolition & site restoration of the existing High School
- Allowance of \$1M for land procurement
- Allowance of \$7.5M for athletic fields

Middle School

- Grades 6-8 configuration
- No referendum work (ADA Toilet Room upgrades completed in the summer of 2019)

Northside Elementary School

- Grades K-5 configuration
- No referendum work

Parkside Elementary School

- Grades K-5 configuration
- No work (HVAC, LED lighting, fire protection, ceiling replacement, Library refresh and ADA Toilet Room upgrades completed in the summer of 2019)

Abe Lincoln Elementary School

- Grades Headstart, 4K & K-5 configuration
- Allowance of \$351k to repair water issues

\$84,860,540

OPTION 5 – INCLUSIONS & EXCLUSIONS

High School

- Grades 9-12 configuration
- 191,672 sqft of new additions / 147,576 sqft of renovating existing space (Includes new Gym & Music renovation)
- Demolition of 60,000 sqft of the existing High School
- Level 1 Remodel includes floors, paint, ceilings, LED lights, HVAC upgrades & (400) lockers
- Level 2 Remodel includes floors, paint, ceilings, minor electrical, LED Lights & HVAC upgrades
- Level 3 Remodel includes floors, paint, ceilings, some new walls, minor plumbing, electrical, LED lights & HVAC upgrades.
- Allowance of \$3M for athletic fields (i.e. (1) baseball field, (2) soccer fields, (8) tennis courts & artificial turf)
- Upgrade front façade
- Repair water leaks & drainage issues
- Replace existing built up & low R-value roofs
- Fire protection system
- Existing PAC upgrades (i.e. rigging, lights, sound, seats, floor, paint & curtain)
- Existing Gym upgrades (i.e. AC, floor, lighting, paint, acoustical panels, scoreboard, basketball hoops & bleachers for one Gym)

Middle School

- Grades 6-8 configuration
- No referendum work (ADA Toilet Room upgrades completed in the summer of 2019)

Northside Elementary School

- Grades K-5 configuration
- No referendum work

Parkside Elementary School

- Grades K-5 configuration
- No referendum work (HVAC, LED lighting, fire protection, ceiling replacement, Library refresh and ADA Toilet Room upgrades completed in the summer of 2019)

Abe Lincoln Elementary School

- Grades Headstart, 4K & K-5 configuration
- Allowance of \$351k to repair water issues

\$78,032,619

PROJECT TIMELINE - DRAFT

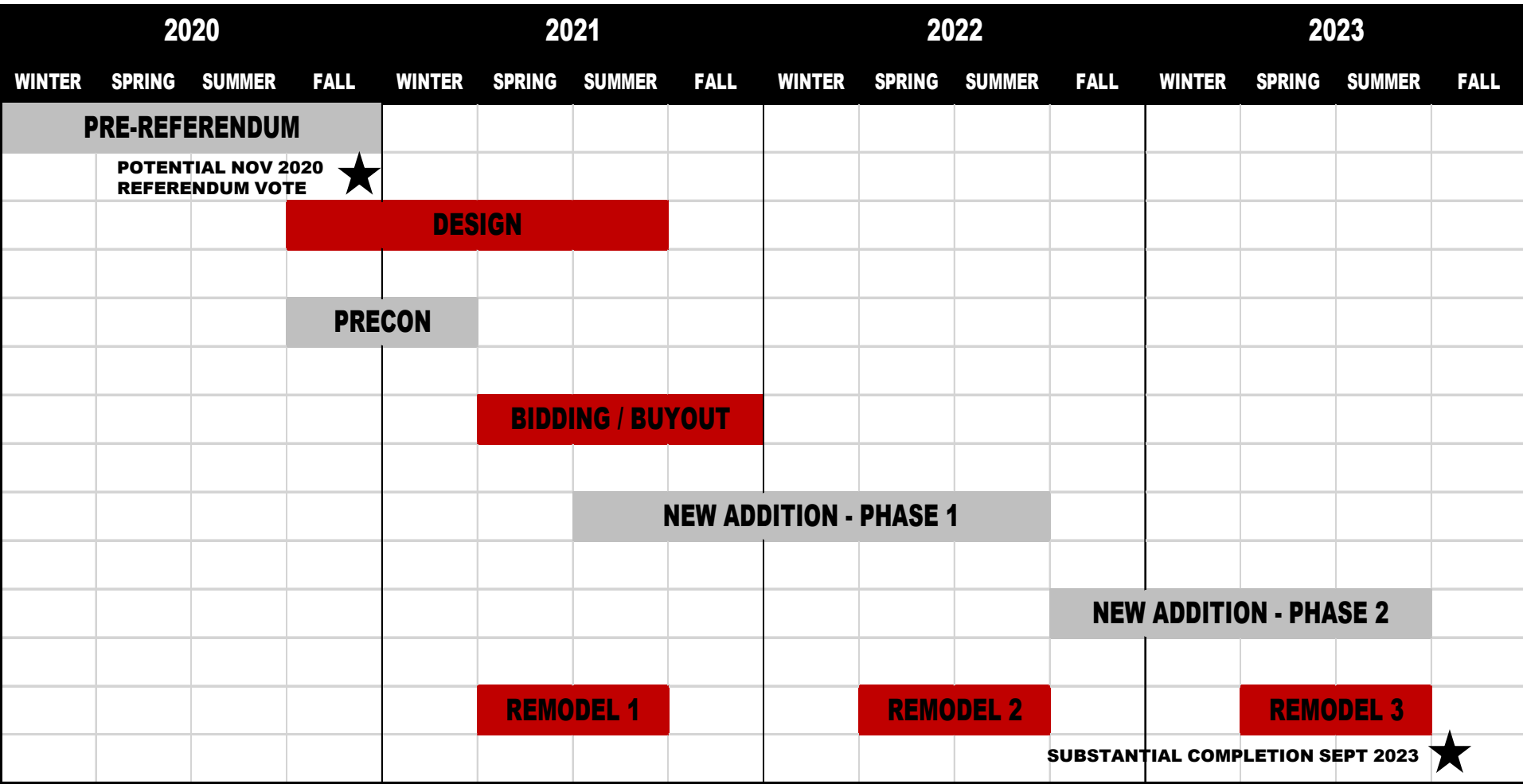

QUESTIONS?

THANK YOU



MONROE SCHOOL
DISTRICT



CGSCHMIDT^{INC.}

pra

PLUNKETT RAYSICH
ARCHITECTS, LLP